

CERTIFIED RECORD OF LAND CORNER MONUMENTATION

R-11

History of original corner establishment:

Original corner established in 1881 by Robb & Graden.

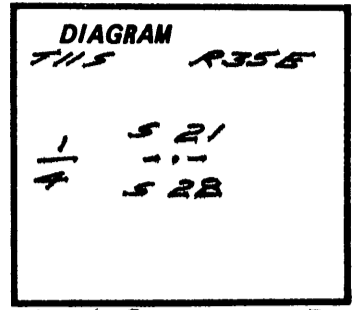

MOS 1115

Set post from which:

A 5" black pine brs. N 30° W 57 lks.
A 8" black pine brs. S 65° E 22 lks.

Description of corner evidence found: *Find. 1 3/4" x 36" iron pipe. Accepted by local surveyors and landowners as corner for many years. Held as corner position.*

Description of monument and accessories I established to perpetuate the original location of this corner: *Set 2 1/4" x 30" aluminum pipe with 2 1/2" aluminum cap rising 4".*

Cap marked

Witnesses:

A 17" PP brs. S 17° E 155.1' marked 1/4 S 28 BT.

T115 R35E

A 5/8" x 30" iron rod with 1 1/2" aluminum cap brs. N 62° E 8.1' *cap mnd. R.M. S 21*

1
4 S 21
S 28
1989
LS 1020

I hereby certify the above corner was perpetuated as described in Aug. 1989.

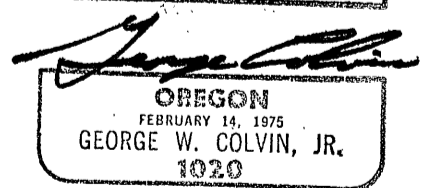
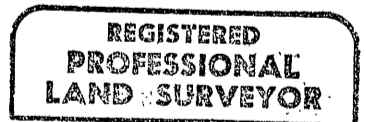

Office of County Surveyor County of Grant
State of Oregon, I hereby certify that the within instrument was filed in this office for record on the 1 day of Dec, 1989
Robert D. Burt by _____
(COUNTY OFFICIAL) (DEPUTY)